

BANCO 01 ESC: 1/20

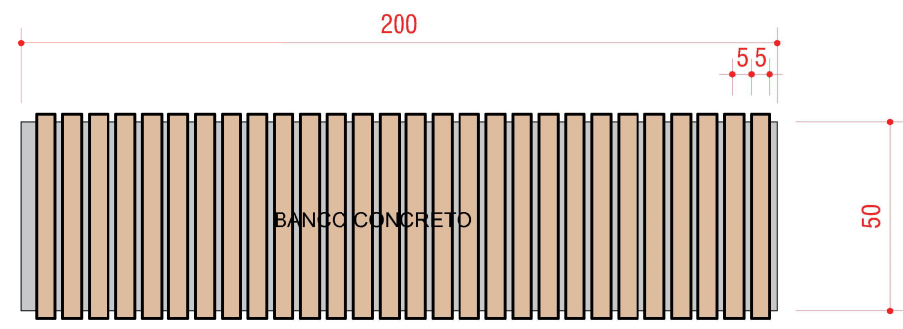

PLANTA BAIXA
ESC: 1/20

ELEVAÇÃO 01
ESC: 1/20

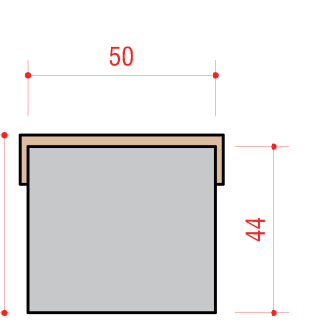

ELEVAÇÃO 02
ESC: 1/20

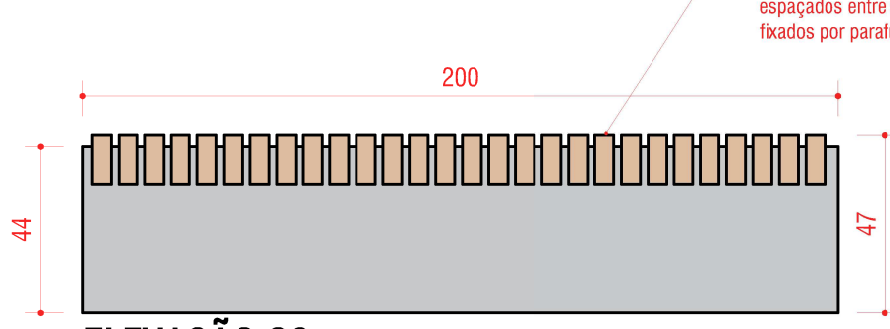

CORTE A
ESC: 1/20

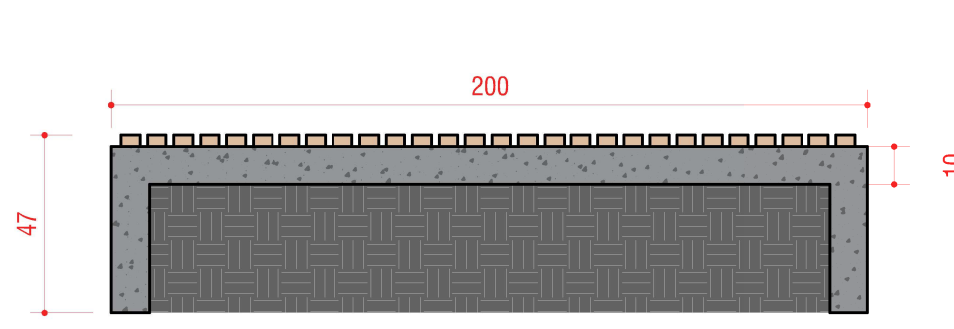

CORTE B
ESC: 1/20

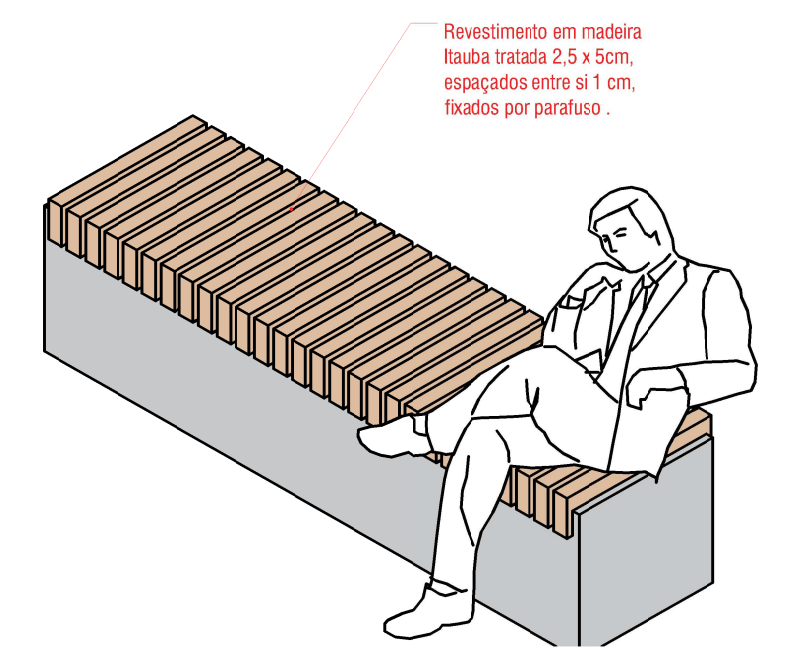
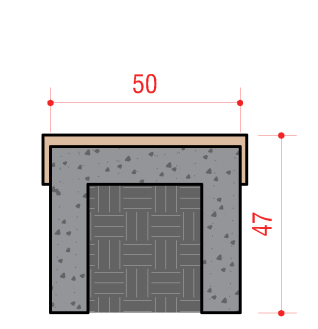

BANCO CONTÍNUO 'S' ESC: 1/25

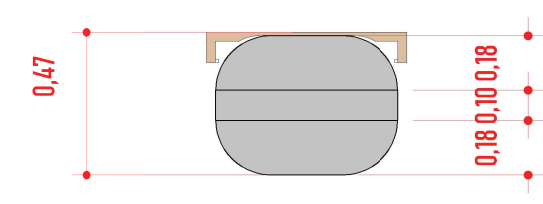

CORTE TRANSVERSAL
ESC: 1/25

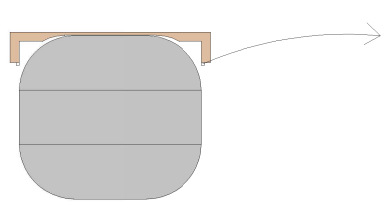

DETALHE ILUMINAÇÃO
ESC: 1/25

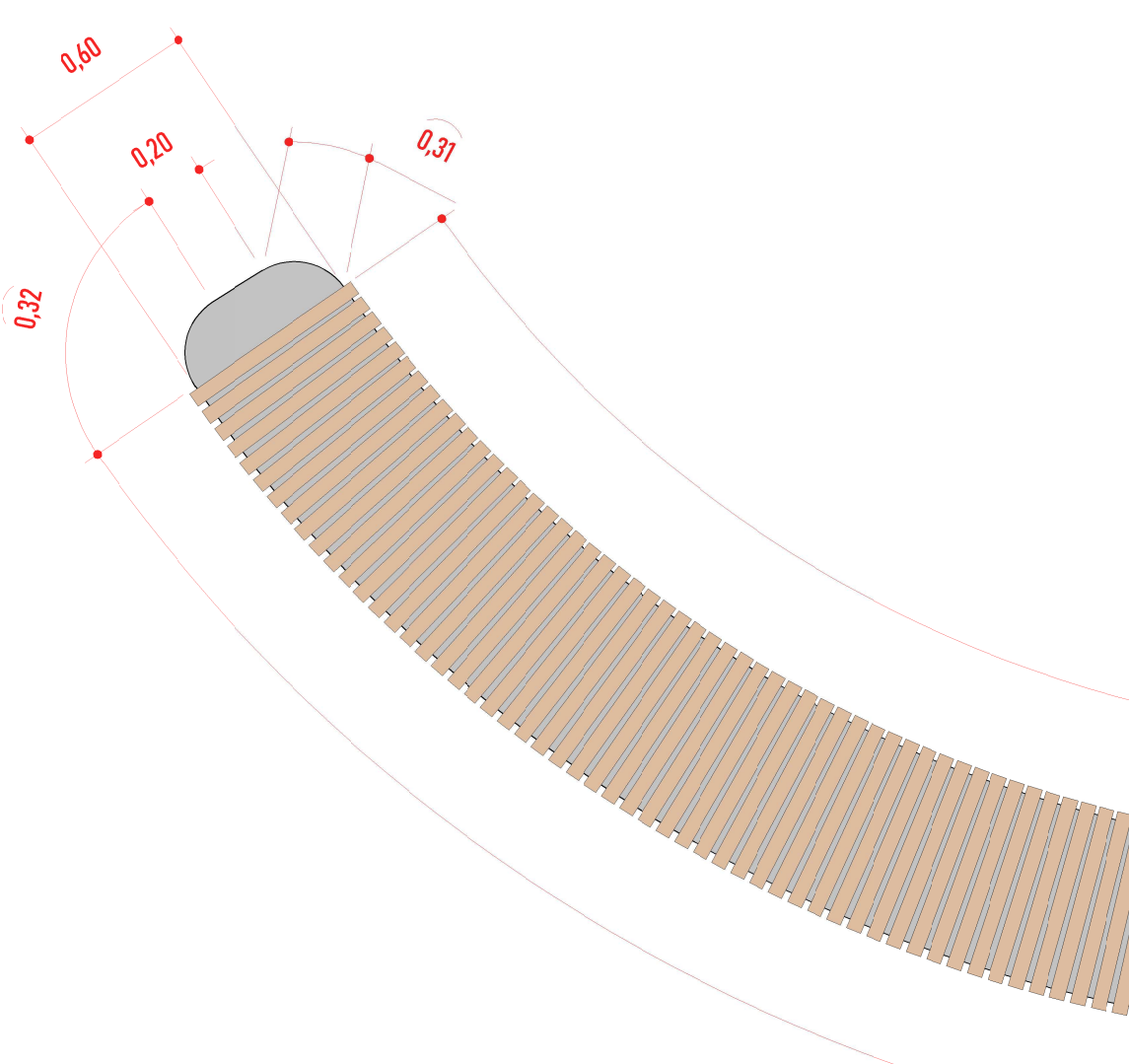

PLANTA BAIXA
ESC: 1/25

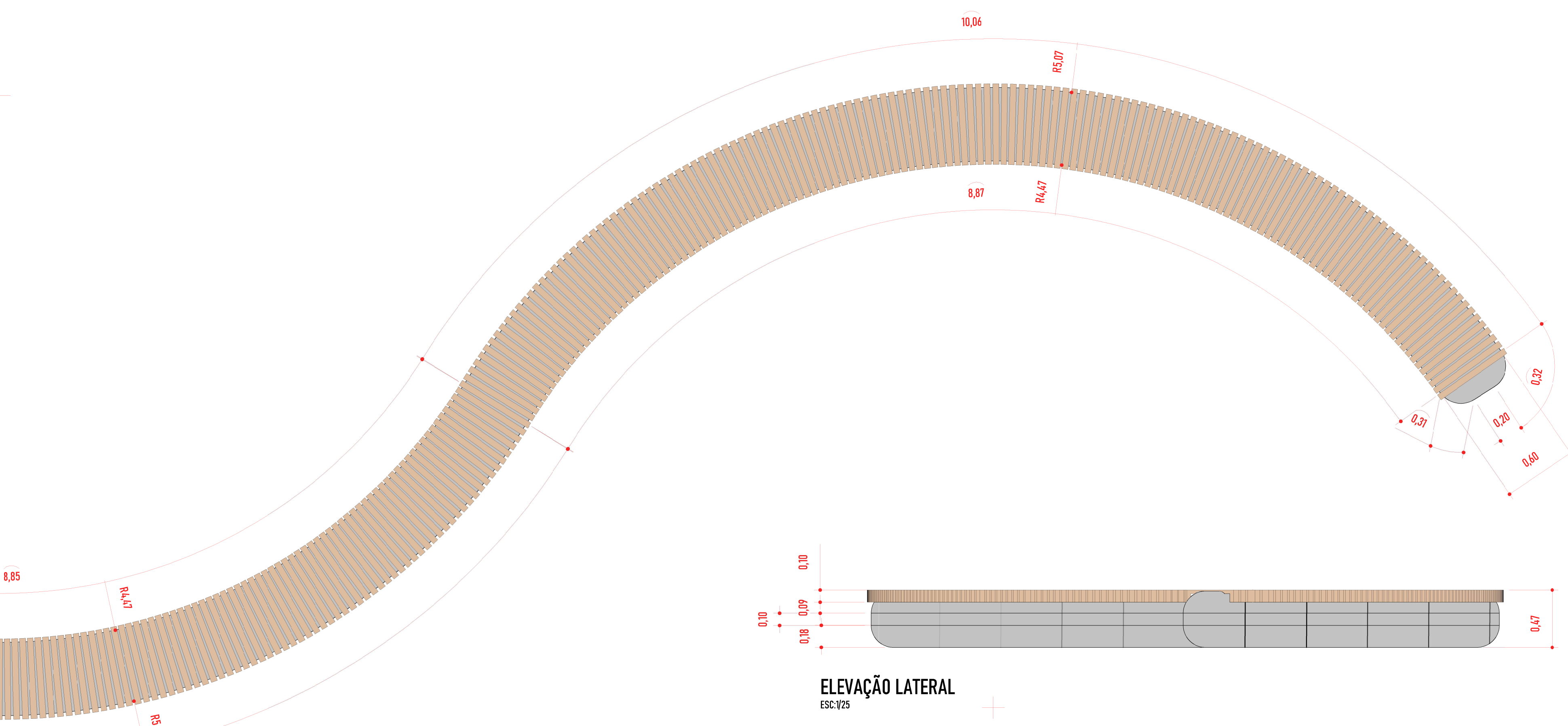

ELEVAÇÃO LATERAL
ESC: 1/25

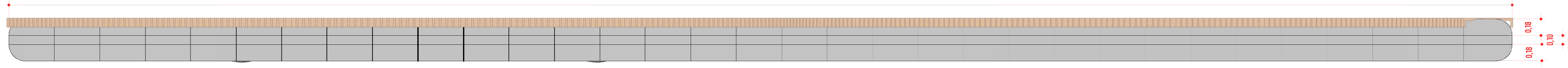

ELEVAÇÃO FRONTAL
ESC: 1/25

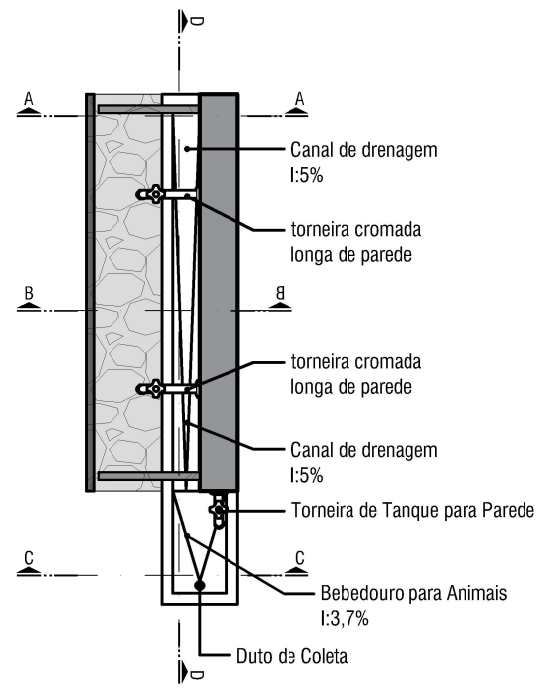

PLANTA BAIXA
ESC: 1/20

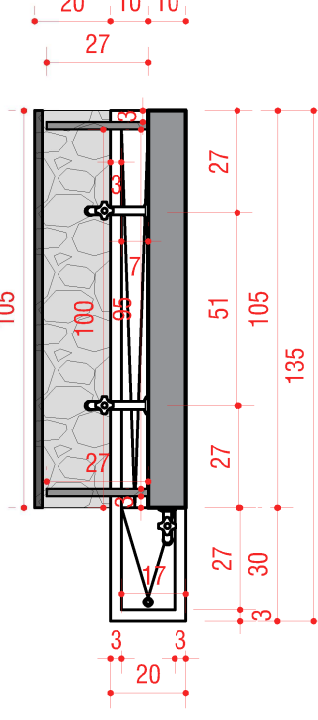

PLANTA BAIXA
ESC: 1/20

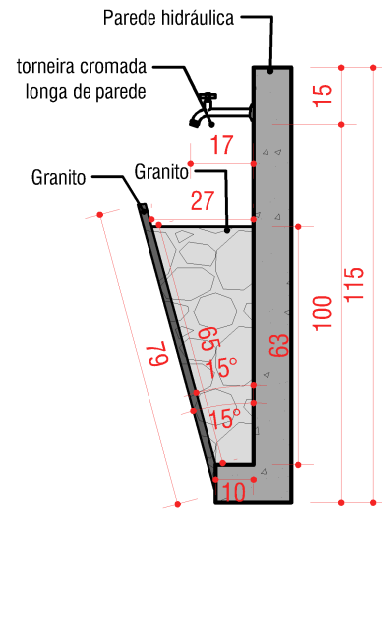

CORTE A
ESC: 1/20

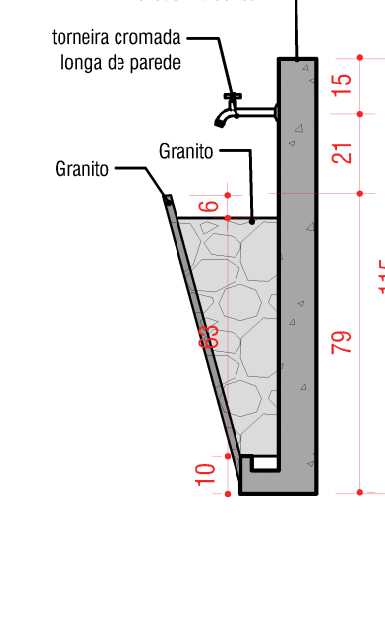

CORTE B
ESC: 1/20

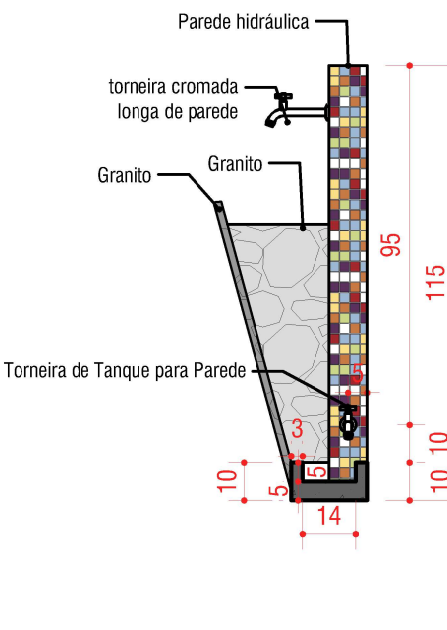

CORTE C
ESC: 1/20

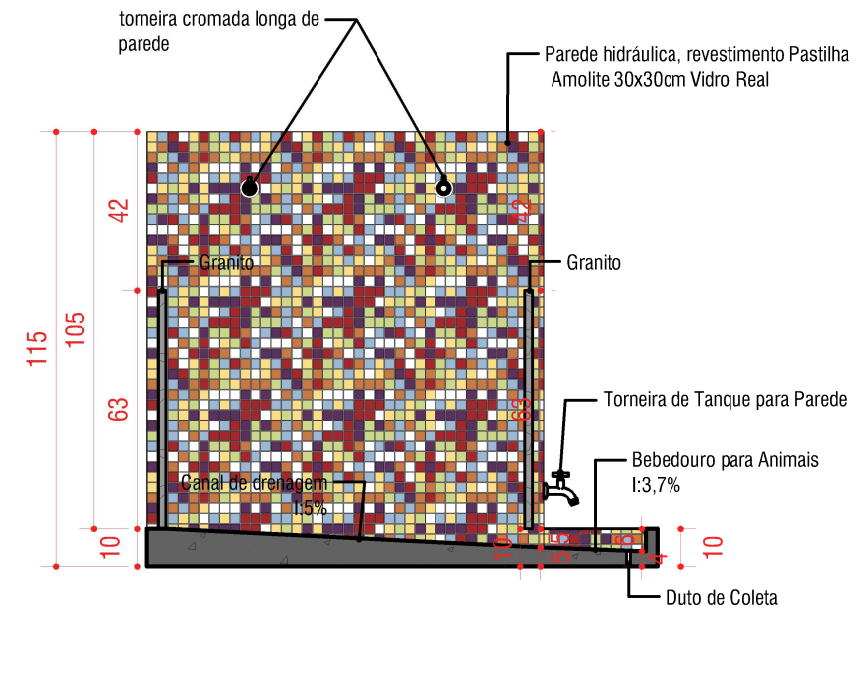

CORTE D
ESC: 1/20

PREFEITURA DE PATO BRANCO
Secretaria de Planejamento Urbano

CARIMBOS P.M.P.B. SECRETARIA DE PLANEJAMENTO URBANO E SAÚDE PÚBLICA

OBRA: PRAÇA DO BARRIO PARQUE DO SOM		ÁREA TOTAL	ESCALA
ESPECIFICAÇÃO: Detalhamento banco 01 e 02 Detalhamento bebedouro		ÁREA ÚTIL	Indicada
AUTOR DO PROJETO ARQUITETÔNICO E URBANÍSTICO	AUTOR DO PROJETO ARQUITETÔNICO E URBANÍSTICO	DATA:	DESCRIÇÃO
PATO BRANCO - CARIMBOS	PATO BRANCO - CARIMBOS	2023	SOM
AUTOR DO PROJETO ARQUITETÔNICO E URBANÍSTICO	AUTOR DO PROJETO ARQUITETÔNICO E URBANÍSTICO	PROPOSTA DE PREÇO	VALOR DA OBRA
PATO BRANCO - CARIMBOS	PATO BRANCO - CARIMBOS	R\$ 100.000,00	R\$ 1.000.000,00

A
05 / 05

planajamurbano@pato Branco.pr.gov.br