

POSTO DE SAÚDE BORTOT
01 - COZINHA

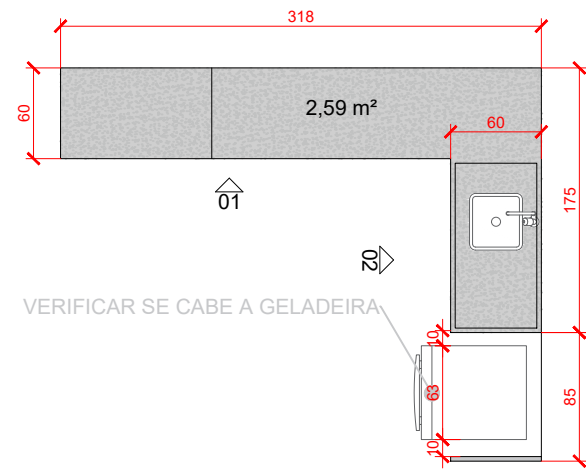

PLANTA BAIXA
ESC: 1/50

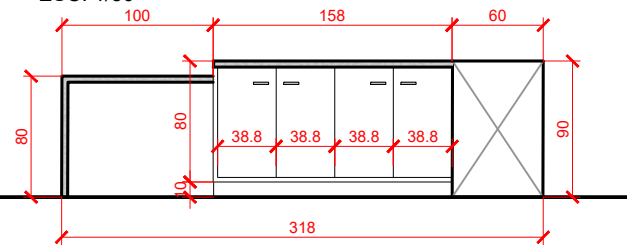

VISTA 01
ESC: 1/50

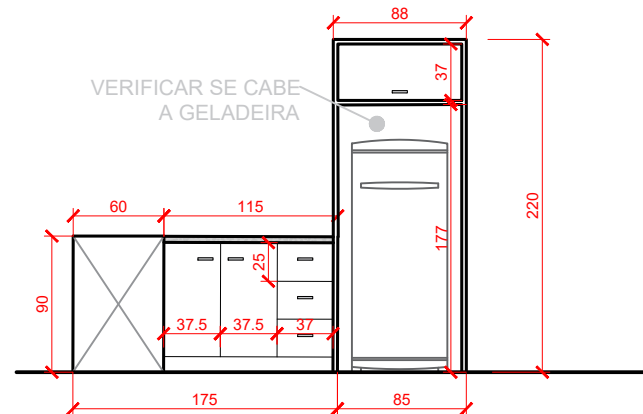

VISTA 02
ESC: 1/50

02- BALCÃO RECEPÇÃO

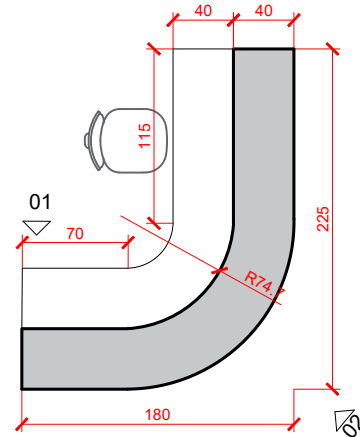

PLANTA BAIXA
ESC: 1/50

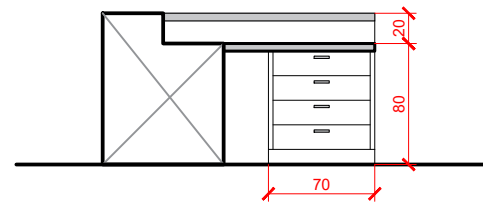

VISTA 01
ESC: 1/50

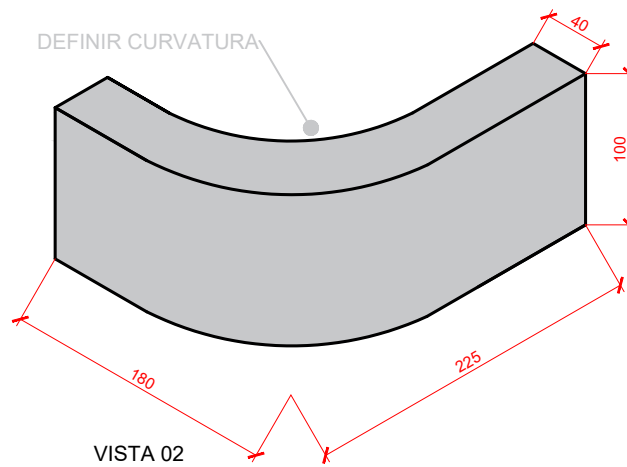

VISTA 02
ESC: 1/50

04- SALA DE VACINA

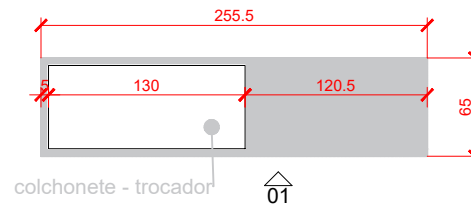

PLANTA BAIXA
ESC: 1/50

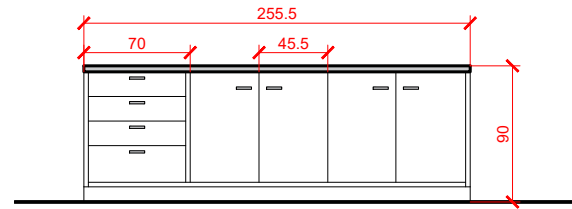

VISTA 01
ESC: 1/50

05- BANCADA

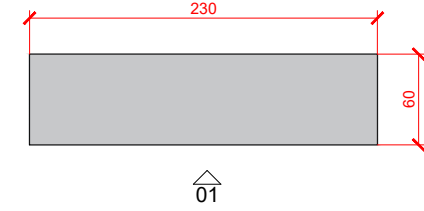

PLANTA BAIXA
ESC: 1/50

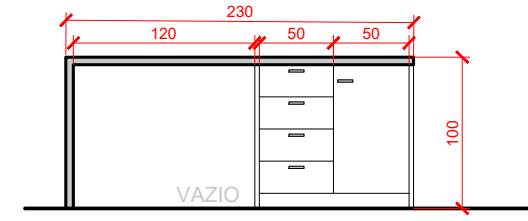

VISTA 01
ESC: 1/50

06- ÁRMARIO

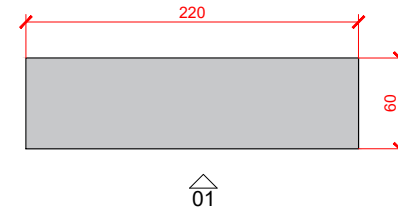

PLANTA BAIXA
ESC: 1/50

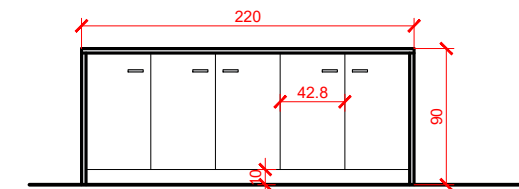

VISTA 01
ESC: 1/50

03- ÁRMARIO GUARDA VOLUME

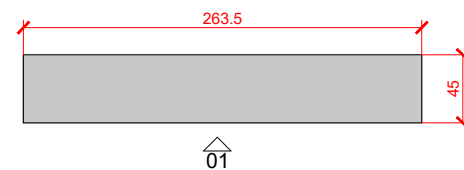

PLANTA BAIXA
ESC: 1/50

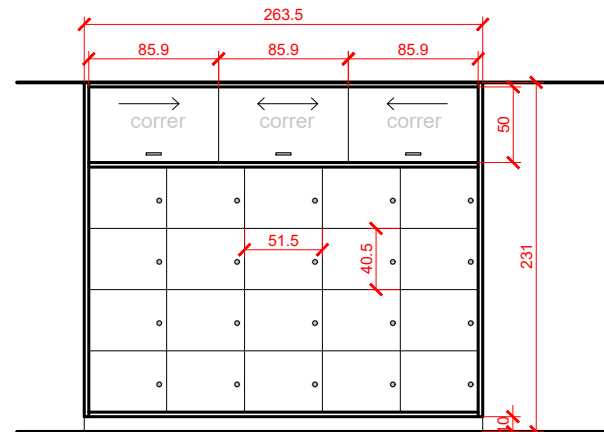

VISTA 01
ESC: 1/50

DETALHAMENTO POSTO BORTOT - MOBILIÁRIO
CONFERIR MEDIDAS IN LOCO ANTES DA EXECUÇÃO DO MOBILIÁRIO
PREVER OS MÓVEIS DUPLOS.

		OBRA: DETALHAMENTO MOBILIÁRIO - POSTO BORTOT	
ESPECIFICAÇÃO: Planta baixa dos mobiliário Vista dos mobiliários com especificação		ÁREA TOTAL -	ESCALA Indicada
AUTOR DO PROJETO ARQUITETO E URBANISTA _____ AUTOR DO PROJETO ARQUITETO E URBANISTA _____ AUTOR DO PROJETO ARQUITETO E URBANISTA _____		DATA 28/06/2022	DESENHO Fabiano Broch
PROPRIETÁRIO Município de Pato Branco 76.995.448/0001-54		PRANCHA A3 A 01/01	
QUADRA	LOTE	ENDEREÇO DA OBRA	MATRÍCULA
VERSÃO	DATA	ALTERAÇÃO	DESENHO